

# Signoret Grand Floor Lamp

TT1101 | 1.0

GENERATION LIGHTING  
PORTABLE

## General Product Information:

This product is safety listed for dry locations only.

This instruction shows a typical installation.

**SAVE THESE INSTRUCTIONS!**

### IMPORTANT SAFETY INSTRUCTIONS

This portable lamp has a polarized plug (one blade is wider than the other) as a safety feature to reduce the risk of electric shock. This plug will fit in a polarized outlet only one way. If the plug does not fit fully in the outlet, reverse the plug. If it still does not fit contact a qualified electrician. Never use with an extension cord unless plug can be fully inserted. Do not attempt to defeat this safety feature.

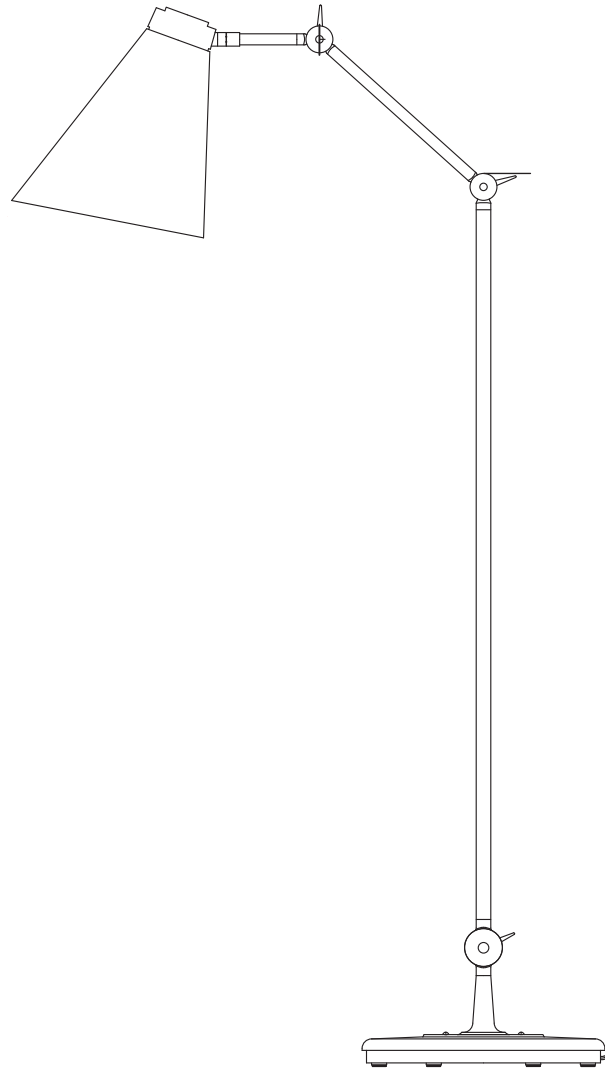

GENERATION LIGHTING  
7400 Linder Ave., Skokie, IL 60077  
T 847.410.4400 | F 847.410.4500  
www.generationlighting.com

# Assemble the Lamp

IA

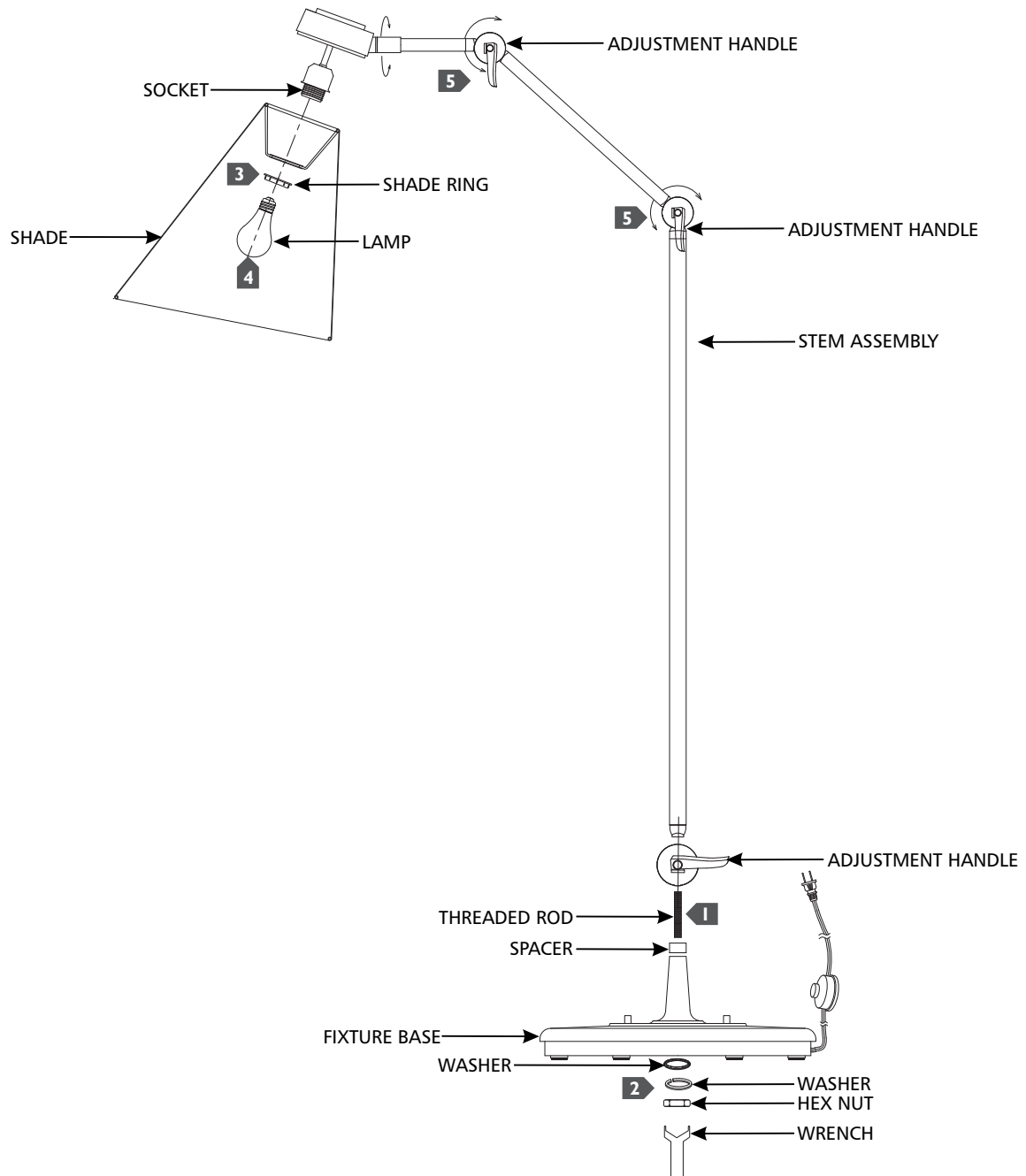

- 1** Slide the adjustment handle over the threaded rod and screw the threaded rod into the stem assembly.
- 2** Insert the threaded rod into the spacer and fixture base and secure with the washers and hex nut using the provided wrench.
- 3** Slide the shade over the socket and secure it with the shade ring.
- 4** Screw the lamp into the socket. Refer to the label on the lamp socket for Max Wattage Information.
- 5** To adjust the fixture use the adjustment handles to raise or lower the fixture as desired.